

COMPANY

st:michel  
BATHROOMWARE

# LEROS WALL 560 DOUBLE DOOR

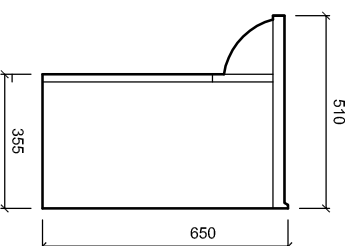
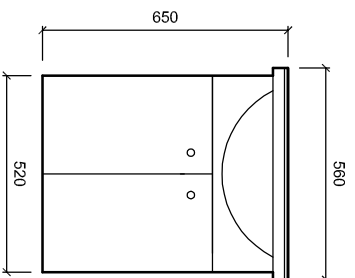
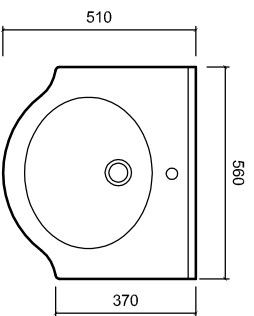

**CONTACT:**

2 Enterprise Drive (off Corban Avenue),  
Henderson,  
Auckland,  
NEW ZEALAND

Phone: 64 (9) 837-4276

Fax: 64 (9) 837-4325

Email: [Info@st:michel.co.nz](mailto:Info@st:michel.co.nz)

Website: [www.st:michel.co.nz](http://www.st:michel.co.nz)

Drawing Title

**LEROS\_WALL\_560**

**NOTE:**

Leros Wall 560 with Leros Basin  
High White Gloss option available

**Xrefs Attached:**

File Name	Scale or Alt.
SMALL SPACES.DWG	1:20
DATE Drawn	JOB No
July 2008	
Drawn By	Revision
NG	A

# LEROS FLOOR 560 DOUBLE DOOR

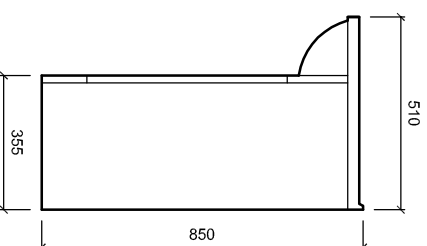
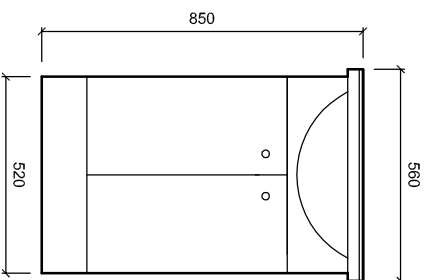
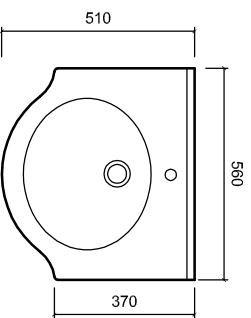

CONTACT:

2 Enterprise Drive (off Corban Avenue),  
Henderson,  
Auckland,  
NEW ZEALAND

Phone 64 (9) 837-4276

Fax 64 (9) 837-4325

Email [info@stmichael.co.nz](mailto:info@stmichael.co.nz)

Website [www.stmichael.co.nz](http://www.stmichael.co.nz)

Drawing Title

## LEROS\_FLOOR\_560

NOTE:

Leros Floor 560 with Leros Basin  
High White Gloss option available

Xrefs Attached:

File Name	Scale of Axi
SMALL SPACES.DWG	1:20
Date Drawn	Job No
July 2008	
Drawn By:	Revision
NG	A