

HETTICH - QUADRO

DRAWER RUNNERS WITH EASY RELEASE FRONT CLIPS

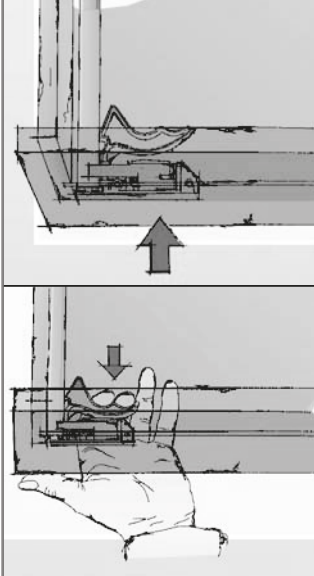

REMOVING DRAWER

Drawers are easily removed by depressing the two blue lever latches positioned on the right and left side behind and under the drawer front.

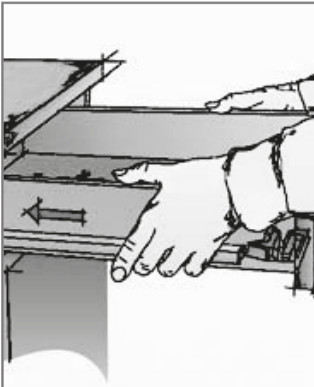

INSERTING DRAWER

To re-insert the drawer, first push the runners back into the cabinet and then slide the drawer on top of the runners back into the closed position. You will hear a **'click'** when the drawer reaches its final closed position, which tells you the front latches are engaged.