

Cabinet Specification

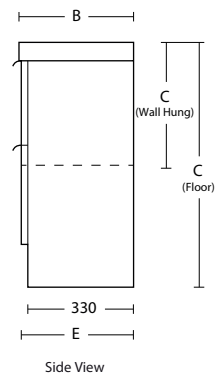

Slim					
Description	A	B	C	D	E
<input type="checkbox"/> Slim Wall 600 2d	600	350	450	594	345
<input type="checkbox"/> Slim Floor 600 2d	600	350	850	594	345
<input type="checkbox"/> Slim Wall 600 1dr	600	350	450	594	345
<input type="checkbox"/> Slim Floor 600 2dr	600	350	850	594	345
<input type="checkbox"/> Slim Wall 900 1 dr (L&R)	900	350	450	894	345
<input type="checkbox"/> Slim Floor 900 2 dr (L&R)	900	350	850	894	345
<input type="checkbox"/> Slim Wall 1200 1d 1dr	1200	350	450	1194	345
<input type="checkbox"/> Slim Floor 1200 1d 2dr	1200	350	850	1194	345

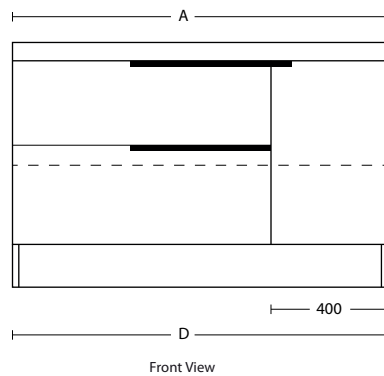
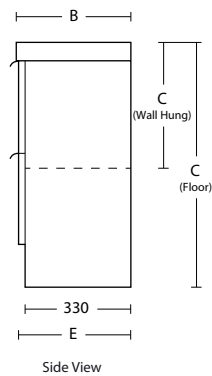
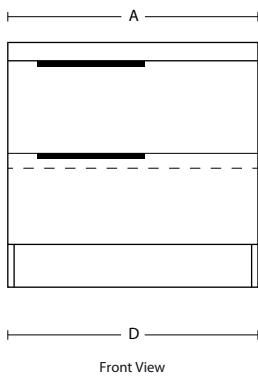

Plumbing Positions

PLEASE NOTE: With wall hung vanities, we suggest you adjust the measurements to suit your individual height preference

Slim 600, 1200

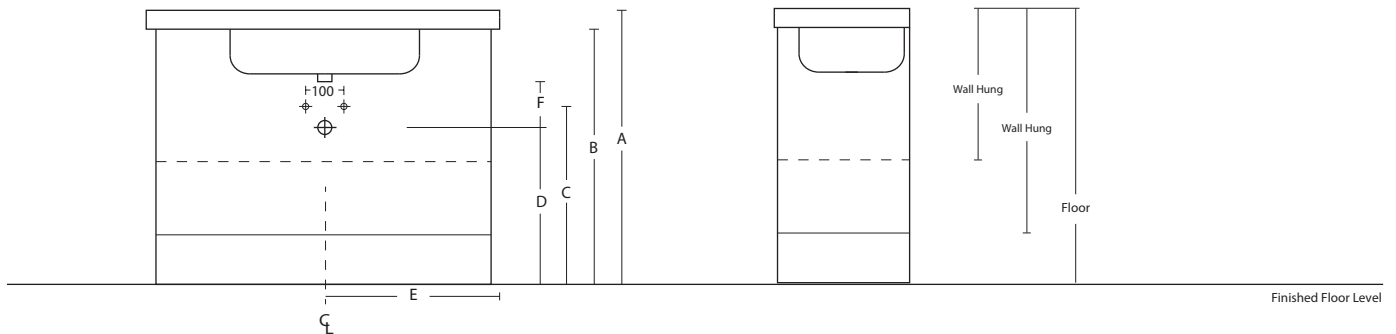

Slim 900 Left

Slim 900 Right

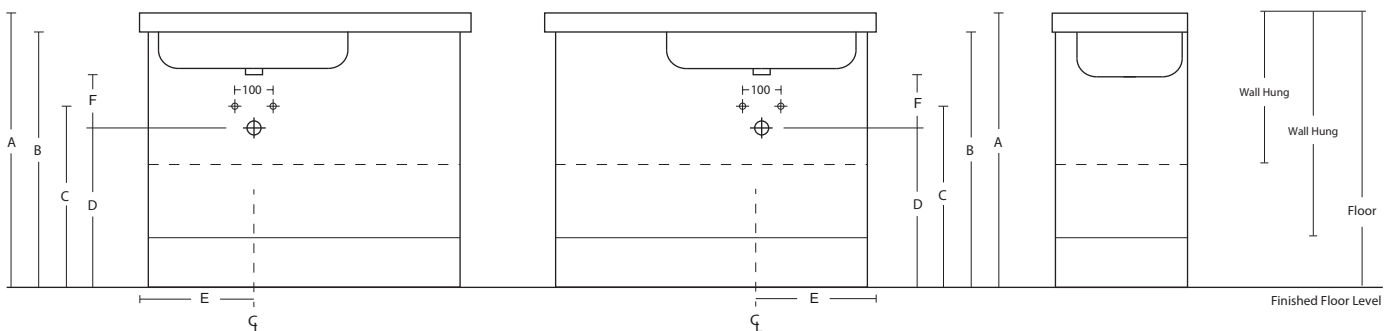

Description	Basin Size	Basin Type	A (Basin Top)	B (Cabinet Height)	C	D	E	F
Selina	Single 600, 1200	Selina - Mineral Cast	850	800	700	640	ϕ Basin	110
Selina	Single 900 Left, 900 Right	Selina - Mineral Cast Left & Right	850	800	700	640	300	110

Standard Supply		<p>If you increase or decrease height of basin (i.e. dimension A) then C + D dimensions must be amended accordingly.</p> <p>F measurement is boottom of basin outlet to centre of wall waste pipe - if another waste trap is used, you will have to confirm F measurement suits or adjust accordingly.</p> <p>NOTE: Waste outlet positioned for standard chrome bottletrap and pop-up basin waste.</p>
Tap Hole	1	
Colour	White	
Integral Overflow	No	