

CABINET SPECIFICATION
City 35 - 1200 - Floor - 1 Door 2 Drawer

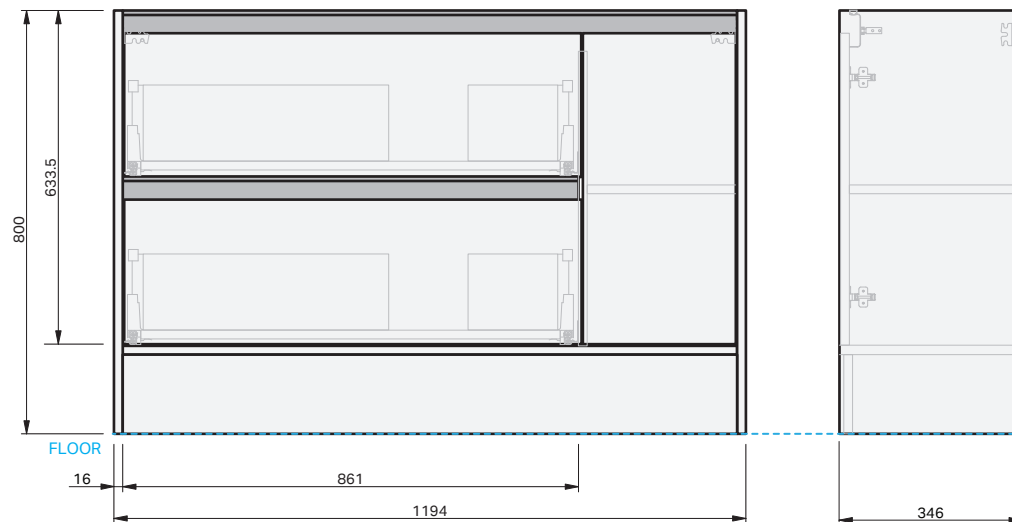

Basin range (refer to applicable basin specification)

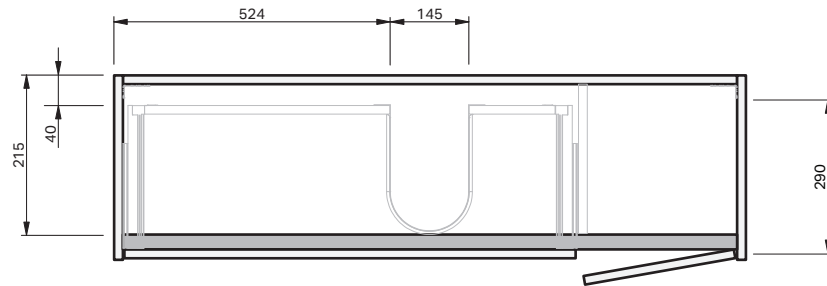

SELINA

- Drawings depict cabinet only
- Waste outlet positioned for standard bottle trap and pop up basin waste



30 YEARS



AQUAEDGE



SOFT
CLOSE

INDICATES FLOOR SURFACE -----

IMPORTANT NOTE: Throughout this guide, dimensions may vary by ± 2 mm. Please read the installation manual for detailed information on installing the product. St. Michel pursues a policy of continuing improvement in design and manufacturing of its products. The right is therefore reserved to vary specifications without notice. For full installation instructions visit stmichel.co.nz.

Date edited:

27/04/2023

01/01